

RF08125 鍊條及標準配件

• 以下提供本產品完整規格說明及訂購資訊

1 訂購資訊

標示例:

RF08125	R	SC	1L	A2	400L	JN
尺寸	滾子型式	材料規格	配件安裝型式	配件	鏈結數	尾端記號

2 規格資訊

資訊表:

產品重量參數總覽

尺寸 / SIZE	節距(P) mm	無配件重量(淨重-kg/m)			A配件重量(kg/個)
		S	R	F	
RF08125	125	4.0	5.8	6.0	0.2

3 材料係數

材料規格代號及抗拉強度

材料規格代號	SC(長備品)	SCZP	SCH	SCHZP	SS	SSH
鍊片	碳鋼HT	+電鍍鋅	合金鋼HT	+電鍍鋅	SUS304	SUS304
軸心、套管、滾子	合金鋼HT	+電鍍鋅	合金鋼HT	+電鍍鋅	SUS304	SUS410HT
最小抗拉強度 kgf	13000		16500		6600	6600

4 滾子形式

R / S / F 型滾子(公制)

R

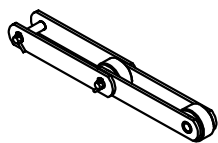
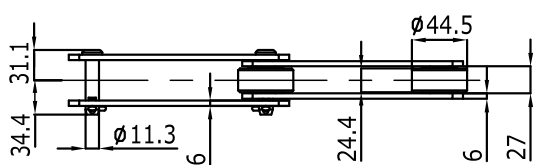

S

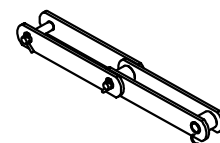
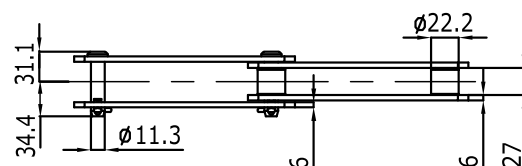

F

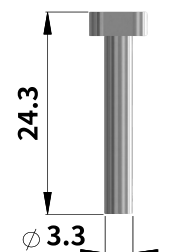
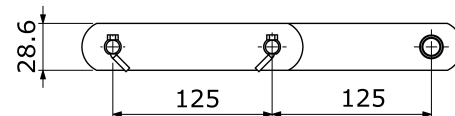
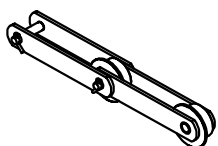
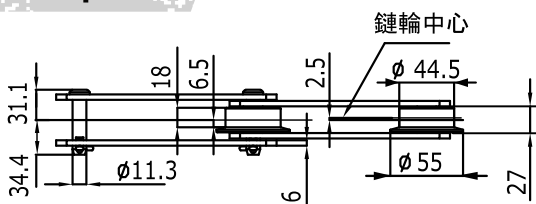

5 配件形式

A1 / A2 / K1 / K2 配件(公制)

1LA1

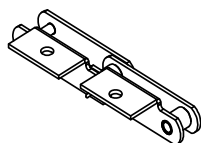
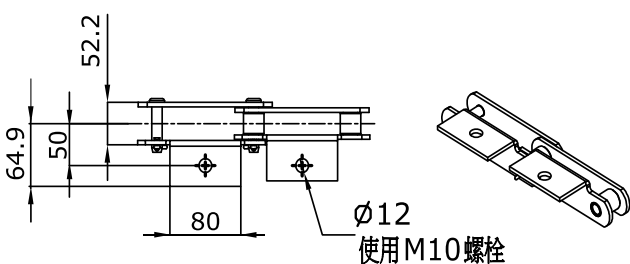

1LA2

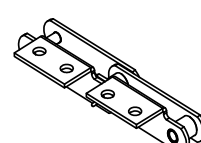
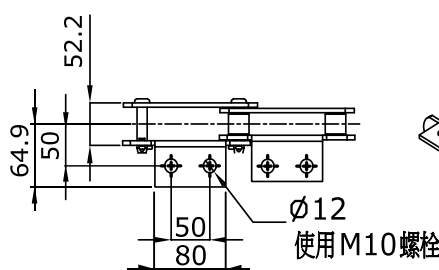

前視圖

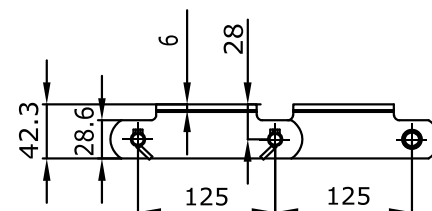

1LK1

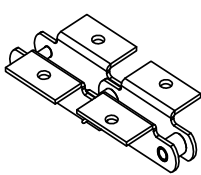
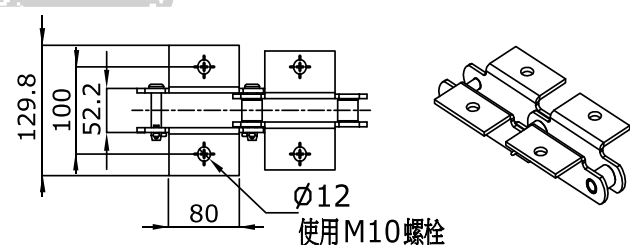

1LK2

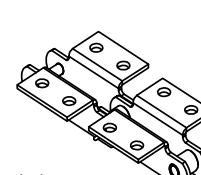
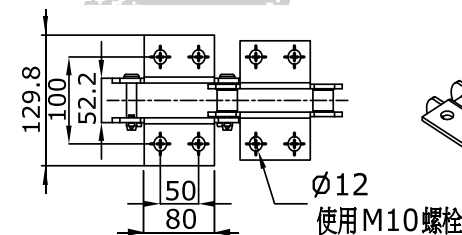

6 記號說明

鏈條兩側尾端記號說明

JN

一邊外目、一邊內目

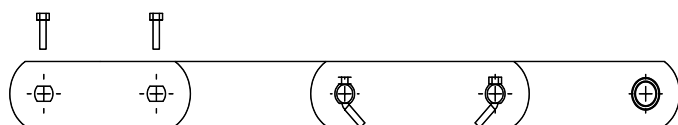

NN

雙邊內目

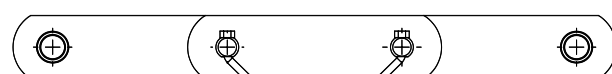

RF08150 鍊條及標準配件

• 以下提供本產品完整規格說明及訂購資訊

1 訂購資訊

標示例:

RF08150	R	SC	1L	A2	400L	JN
尺寸	滾子型式	材料規格	配件安裝型式	配件	鏈結數	尾端記號

2 規格資訊

資訊表:

產品重量參數總覽

尺寸 / SIZE	節距(P) mm	無配件重量(淨重-kg/m)			A配件重量(kg/個)
		S	R	F	
RF08150	150	3.8	5.3	5.5	0.22

3 材料係數

材料規格代號及抗拉強度

材料規格代號	SC(長備品)	SCZP	SCH	SCHZP	SS	SSH
鍊片	碳鋼HT	+電鍍鋅	合金鋼HT	+電鍍鋅	SUS304	SUS304
軸心、套管、滾子	合金鋼HT	+電鍍鋅	合金鋼HT	+電鍍鋅	SUS304	SUS410HT
最小抗拉強度 kgf	13300		16500		6600	6600

4 滾子形式

R / S / F 型滾子(公制)

R

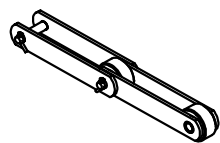
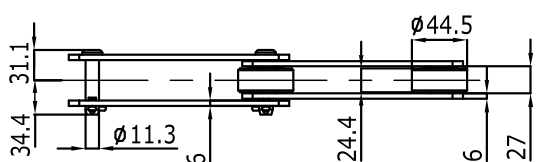

S

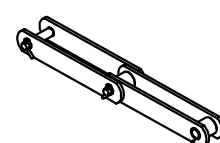
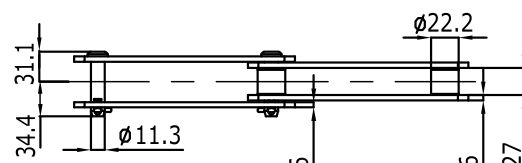

F

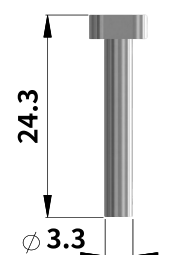
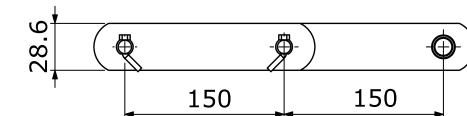
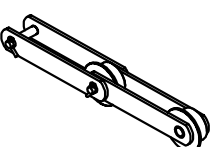

5 配件形式

A1 / A2 / K1 / K2 配件(公制)

1LA1

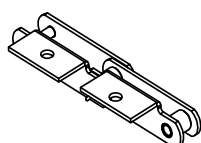
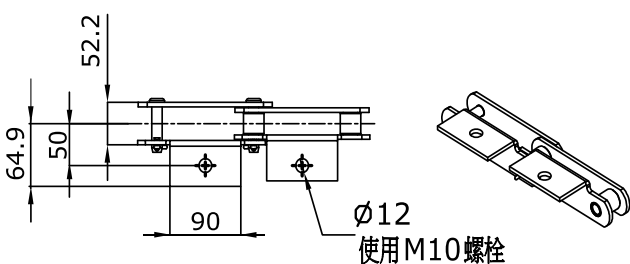

1LA2

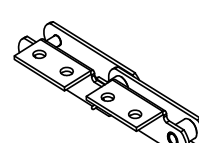
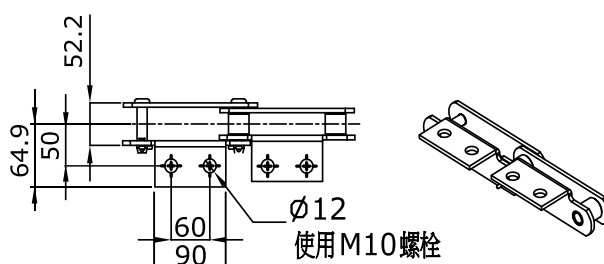

前視圖

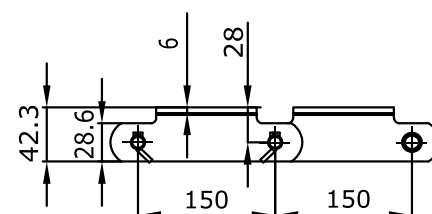

1LK1

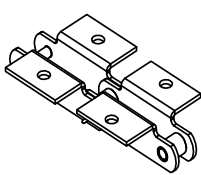
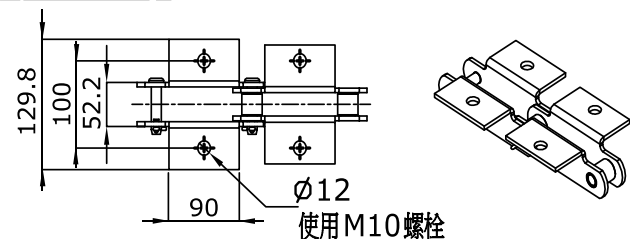

1LK2

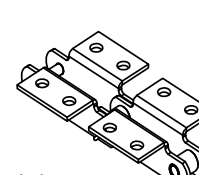
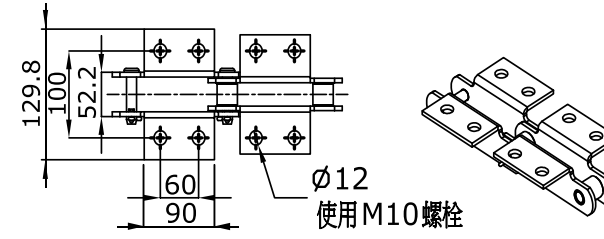

6 記號說明

鏈條兩側尾端記號說明

JN
一邊外目、一邊內目

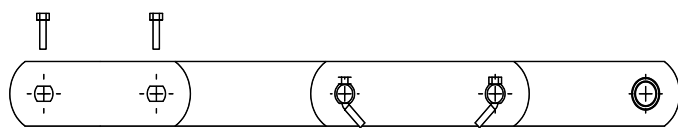

NN
雙邊內目

